

## PUSH-IN FASTENERS

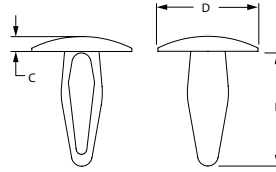

### MMB Series Mini Mounting Button



## Specifications:

- Material: Nylon 6/6
- Color: Black or Natural
- Flame Class: UL94V-2

Item No.		Hole Dia.		Panel Thickness		Ø D		C		E		Pack Qty.
		In	mm	In	mm	In	mm	In	mm	In	mm	
MMB-125-01BK	MMB-125-01	0.125	3.18	0.080 - 0.100	2.0 - 2.5	0.270	6.9	0.040	1.0	0.330	8.4	1000
MMB-130-01BK	MMB-130-01	0.132	3.35	0.060 - 0.130	1.6 - 3.2	0.280	7.1	0.060	1.5	0.390	9.9	1000
MMB-136-01BK	MMB-136-01	0.136	3.45	0.120 - 0.160	2.9 - 4.0	0.410	10.3	0.070	1.7	0.440	11.1	1000
MMB-187-01BK	MMB-187-01	0.187	4.75	0.100 - 0.160	2.5 - 4.0	0.500	12.7	0.090	2.2	0.430	10.9	1000
MMB-210-01BK	MMB-210-01	0.210	5.33	0.100 - 0.160	2.5 - 4.0	0.551	14.0	0.118	3.0	0.551	14.0	1000
MMB-132-01BK	MMB-132-01	0.215	5.46	0.060 - 0.130	1.6 - 3.2	0.370	9.4	0.060	1.5	0.450	11.5	1000
MMB-250-01BK	MMB-250-01	0.250	6.35	0.100 - 0.220	2.5 - 5.6	0.500	12.7	0.090	2.2	0.640	16.3	1000

### ARW Series Arrow Clips



## Specifications:

- Material: Nylon 6/6
- Color: Natural

## Features:

- Push down to install

Item No.	D	h	H	A	Hole Dia.	Panel Thickness Range (In)	Pack Qty.
ARW010A	0.100	0.020	0.125	0.068	0.062 - 0.065	.010 - .031	1000
ARW020A	0.270	0.040	0.330	0.140	0.120 - 0.135	.062 - .125	1000
ARW030A	0.280	0.040	0.390	0.196	0.151 - 0.161	.062 - .125	1000
ARW040A	0.280	0.080	0.400	0.180	0.151 - 0.161	.062 - .145	1000
ARW050A	0.360	0.060	0.400	0.225	0.182 - 0.192	.062 - .125	1000
ARW060A	0.370	0.060	0.540	0.225	0.182 - 0.192	.310 - .330	1000
ARW070A	0.375	0.060	0.525	0.206	0.182 - 0.192	.165 - .185	1000

Item No.	D	h	H	A	Hole Dia.	Panel Thickness Range (In)	Pack Qty.
ARW080A	0.270	0.070	0.528	0.202	0.182 - 0.192	.200 - .250	1000
ARW090A	0.370	0.060	0.450	0.248	0.213 - 0.223	.125 - .187	1000
ARW100A	0.370	0.060	0.540	0.227	0.213 - 0.223	.062 - .125	1000
ARW110A	0.750	0.055	0.632	0.281	0.240 - 0.260	.095 - .218	1000
ARW120A	0.484	0.060	0.575	0.290	0.250 - 0.261	.125 - .187	1000
ARW130A	0.615	0.065	0.810	0.286	0.250 - 0.262	.360 - .380	1000
ARW140A	0.610	0.068	1.135	0.287	0.250 - 0.263	.500 - .750	1000

### DF Series Drive Fastener



## Specifications:

- Color: Natural

## Features:

- Multi-purpose front loaded fastener
- Can be used as a decorative hole plug
- Inserts easily by hand
- Hollow body increases flexibility for ease of insertion and removal

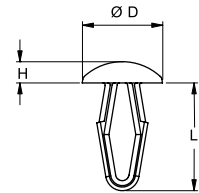

Item No.	Item No.	Hole Ø		Total Holding Thickness		D Ø		H		L Ref.		Pack Qty.
Material: UL94 HB Acetal	Material: UL94 V-0 Nylon 6/6	In	mm	In	mm	In	mm	In	mm	In	mm	
DF-137-010	DFVO-137-010	.126	3.2	.039 - .177	1.0 - 4.5	.315	8.0	.059	1.5	.512	13.0	1000
DF-137-020	DFVO-137-020	.153	3.9	.039 - .197	1.0 - 5.0	.354	9.8	.063	1.6	.551	14.0	1000
DF-137-030	DFVO-137-030	.185	4.7	.039 - .216	1.0 - 5.5	.394	10.0	.067	1.7	.590	15.0	1000
DF-137-031	DFVO-137-031	.185	4.7	.039 - .216	1.0 - 5.5	.433	11.0	.114	2.9	.590	15.0	1000
DF-137-040	DFVO-137-040	.252	6.4	.059 - .256	1.5 - 6.5	.472	12.0	.079	2.0	.669	17.0	1000
DF-137-050	DFVO-137-050	.307	7.8	.059 - .275	1.5 - 7.0	.551	14.0	.087	2.2	.748	19.0	1000
DF-137-060	DFVO-137-060	.216	5.5	.236 - .354	6.0 - 9.0	.472	12.0	.079	2.0	.689	17.5	1000

### MB Series Mounting Button



## Specifications:

- Material: Nylon 6/6
- Color: Natural
- Flame Class: UL94V-2

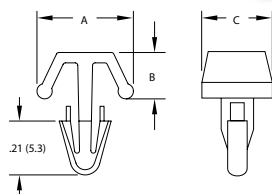

Item No.	Hole Diameter		Panel Thickness		A Ref.		B Ref.		C		Pack Qty.
	In	mm	In	mm	In	mm	In	mm	In	mm	
MB-1-156	0.156	4.0	0.031 - 0.093	0.8 - 2.4	0.391	9.9	0.188	4.8	0.310	7.9	1000
MB-3-156	0.156	4.0	0.093 - 0.156	2.4 - 4.0	0.391	9.9	0.188	4.8	0.310	7.9	1000
MB-5-156	0.156	4.0	0.156 - 0.219	4.0 - 5.6	0.391	9.9	0.188	4.8	0.310	7.9	1000
MB-7-156	0.156	4.0	0.219 - 0.281	5.6 - 7.1	0.391	9.9	0.188	4.8	0.310	7.9	1000
MB-9-156	0.156	4.0	0.281 - 0.343	7.1 - 8.7	0.391	9.9	0.188	4.8	0.310	7.9	1000
MB-11-156	0.156	4.0	0.343 - 0.406	8.7 - 10.3	0.391	9.9	0.188	4.8	0.310	7.9	1000
MB-1-187	0.187	4.8	0.031 - 0.093	0.8 - 2.4	0.484	12.3	0.188	4.8	0.310	7.9	1000
MB-3-187	0.187	4.8	0.093 - 0.156	2.4 - 4.0	0.484	12.3	0.188	4.8	0.310	7.9	1000
MB-5-187	0.187	4.8	0.156 - 0.219	4.0 - 5.6	0.484	12.3	0.188	4.8	0.310	7.9	1000
MB-7-187	0.187	4.8	0.219 - 0.281	5.6 - 7.1	0.484	12.3	0.188	4.8	0.310	7.9	1000
MB-9-187	0.187	4.8	0.281 - 0.343	7.1 - 8.7	0.484	12.3	0.188	4.8	0.310	7.9	1000
MB-11-187	0.187	4.8	0.343 - 0.406	8.7 - 10.3	0.484	12.3	0.188	4.8	0.310	7.9	1000